



INSTALLATION INSTRUCTIONS

glassSTACKWALL > Frameless

VERSION 1.1

Table of Contents

Required Tools	-----	1
Panel Assembly	-----	6
System Assembly	-----	28

REQUIRED TOOLS

Part-1.

Tools required for the panel assembly:

Allen metric key set or use only the following three (3) allen keys:

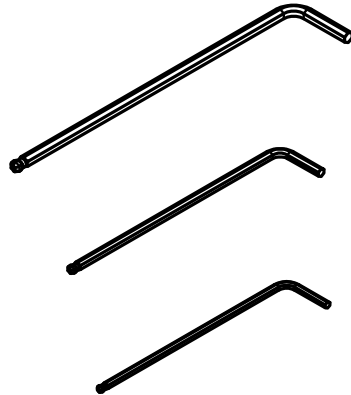
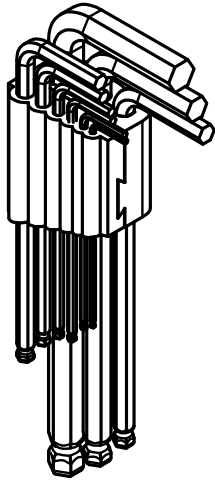

5mm allen key

3mm allen key

2.0mm allen key

Measuring tape

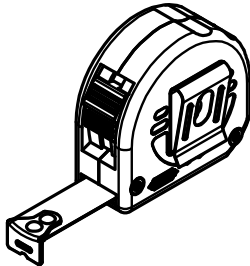

Suction cups

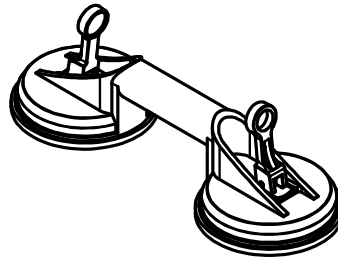

Saw horse with carpet or protected to prevent glass damage

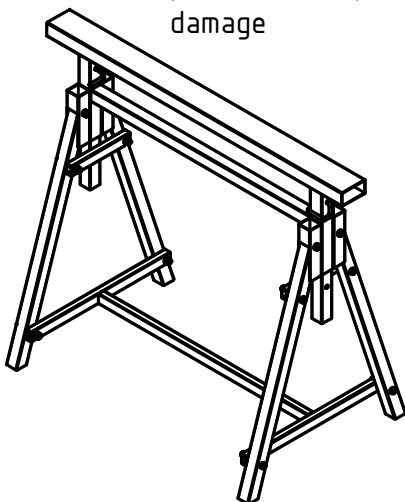

Silicone or RTV 408 gun

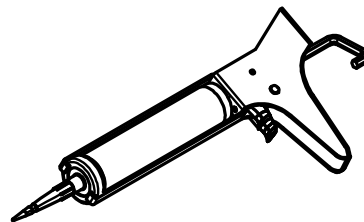

REQUIRED TOOLS

Drills

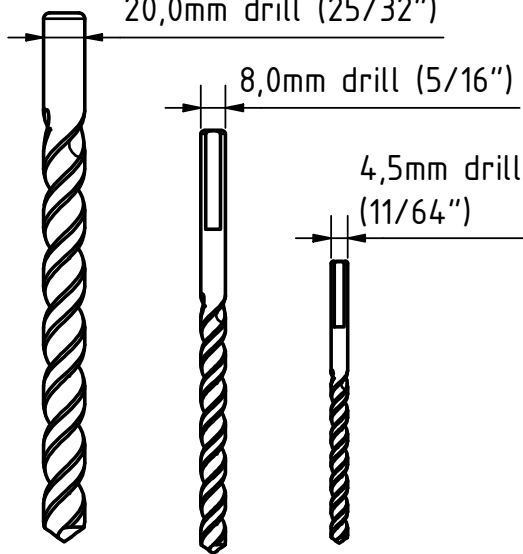

Portable drill machine
(NOT impact drill)

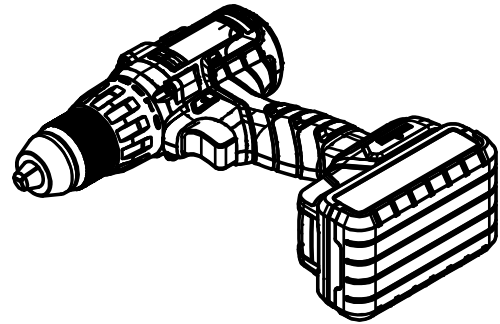

Screwdrivers
Flat head & Philips

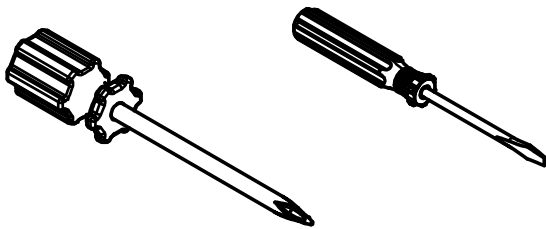

Knife



Rubber mallet

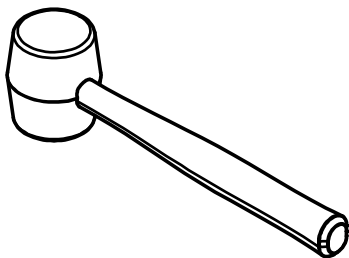

10mm Key

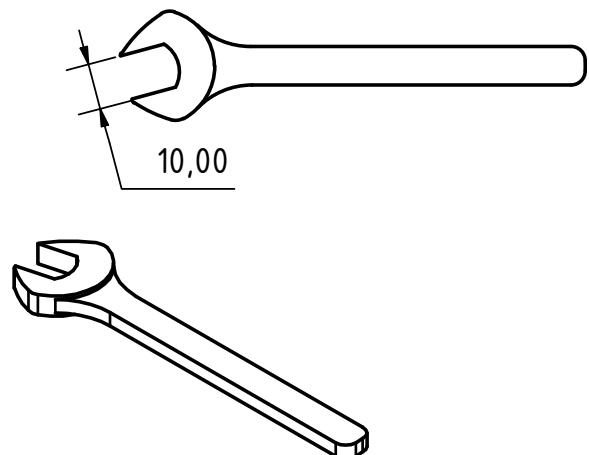

PARTS SUPPLIED BY CARVART

Top track connectors
(4mm stainless steel pins)

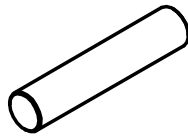

729.942 STOP

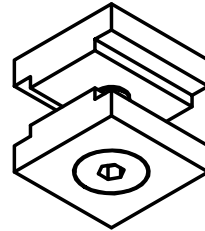

Top track connectors

729.657

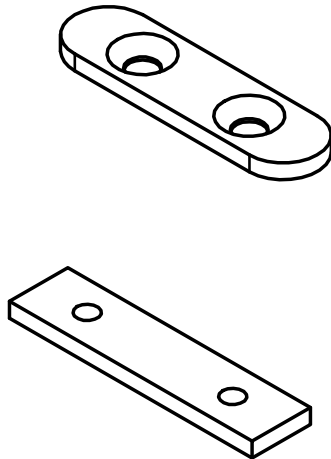

999.936 Lock casing
(Dust-proof strike)

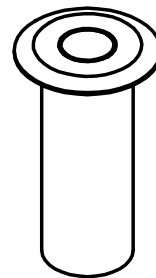

PLASTIC SPACER FOR GLASS

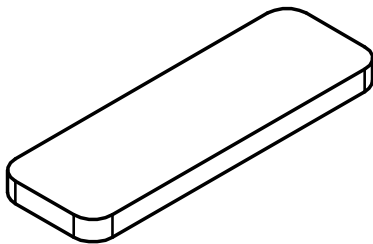

ST.STEEL SHEET METAL
ROUND HEAD
SCREWS 4.8x32

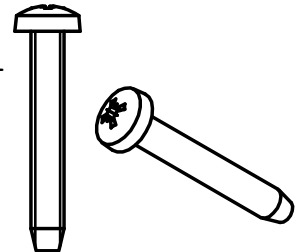

ST.STEEL SHEET METAL
COUNTERSHUNK
SCREWS 4.8x32

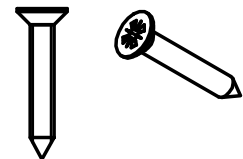

REQUIRED TOOLS

Brush for guide profile
and for panels



Rubber sealing profile
and for panels

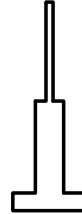

Rubber sealing profile
and for panels



Rubber sealing profile
and for the glass assembly
into the panels

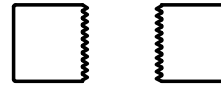

729.522

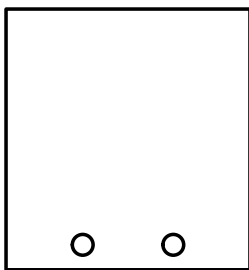

729.941 STOP

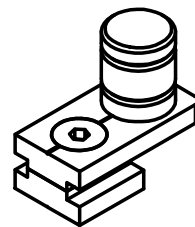

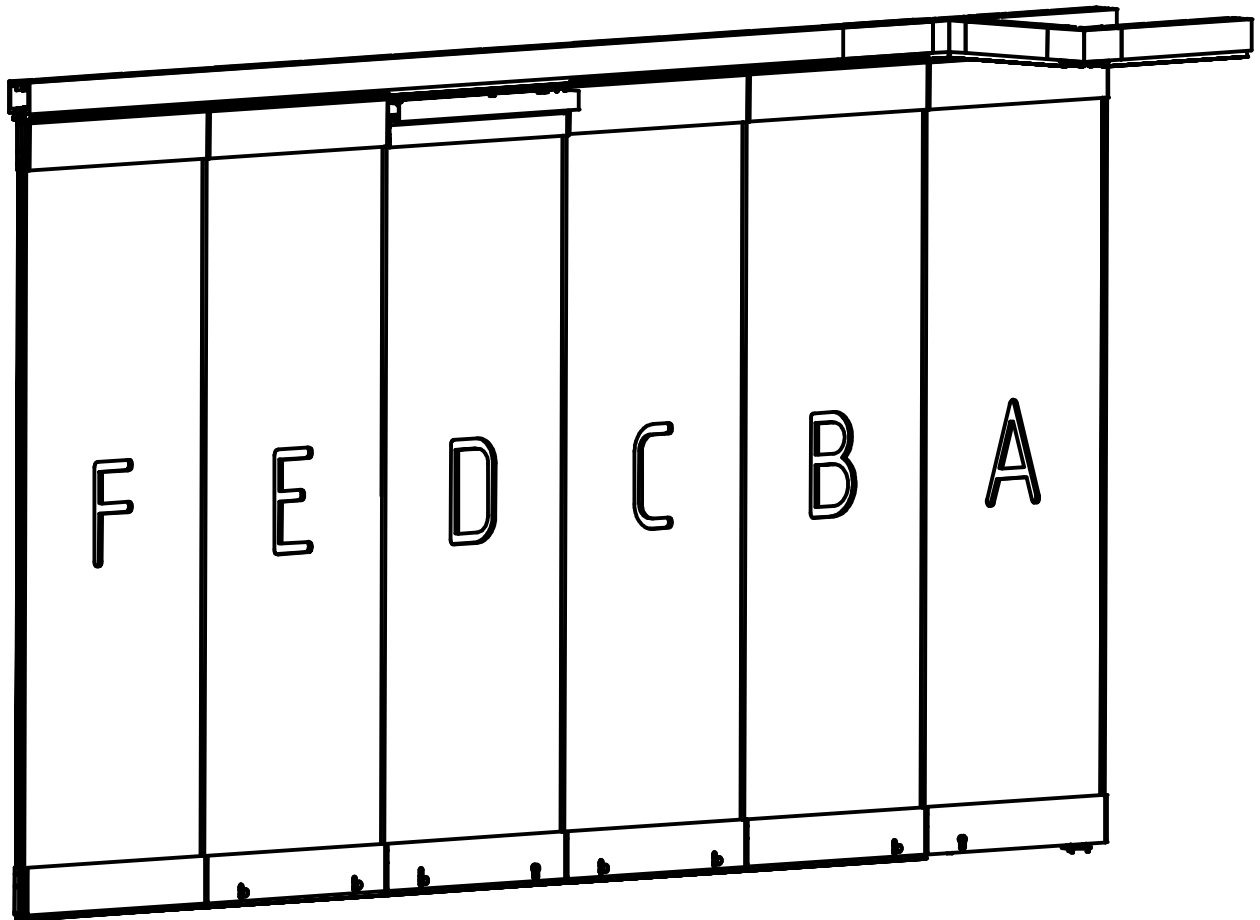

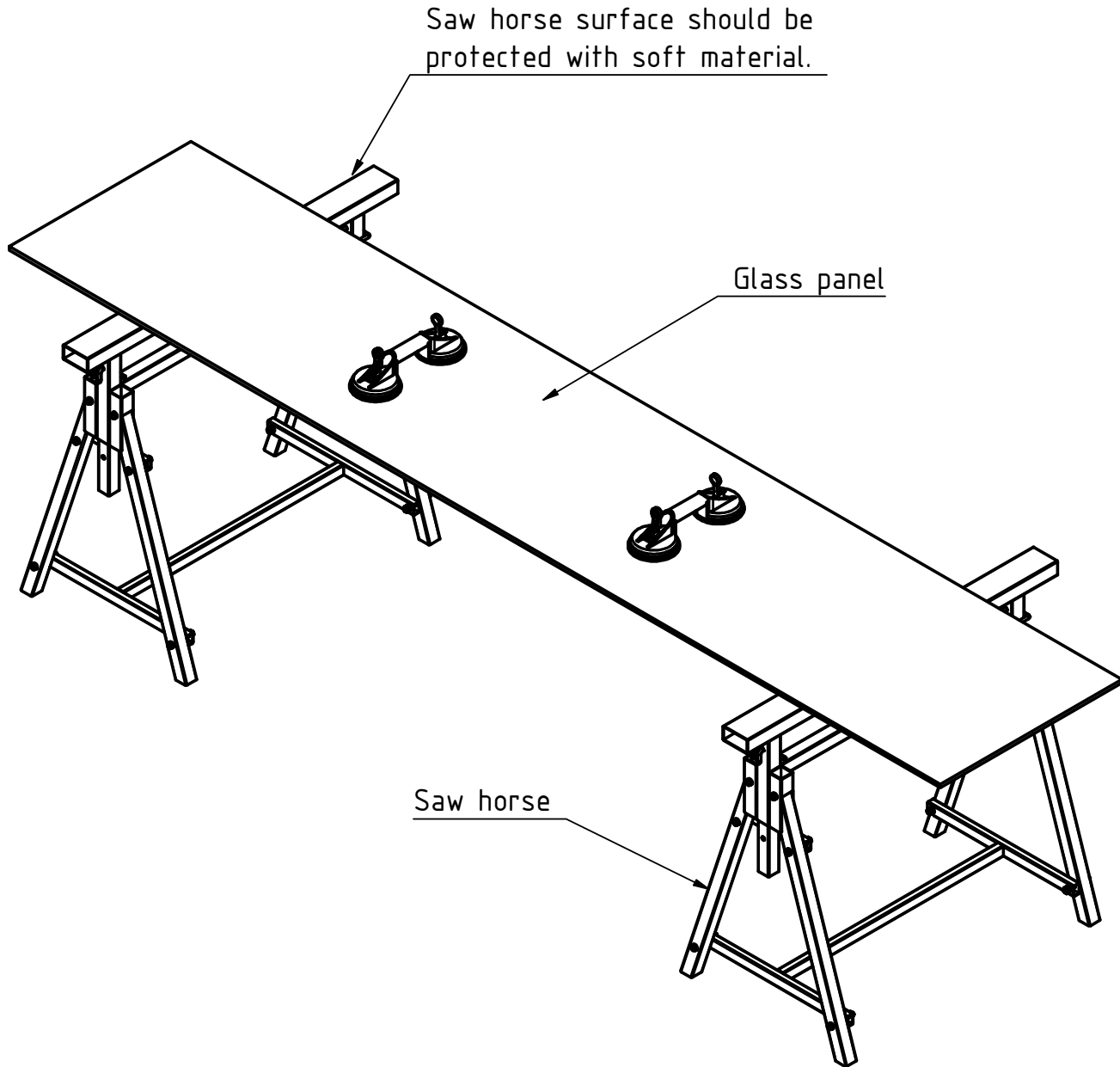

STEP-1:

Place the glass on the saw horses.

Make the sure that the saw horse surface is protected with a soft material.

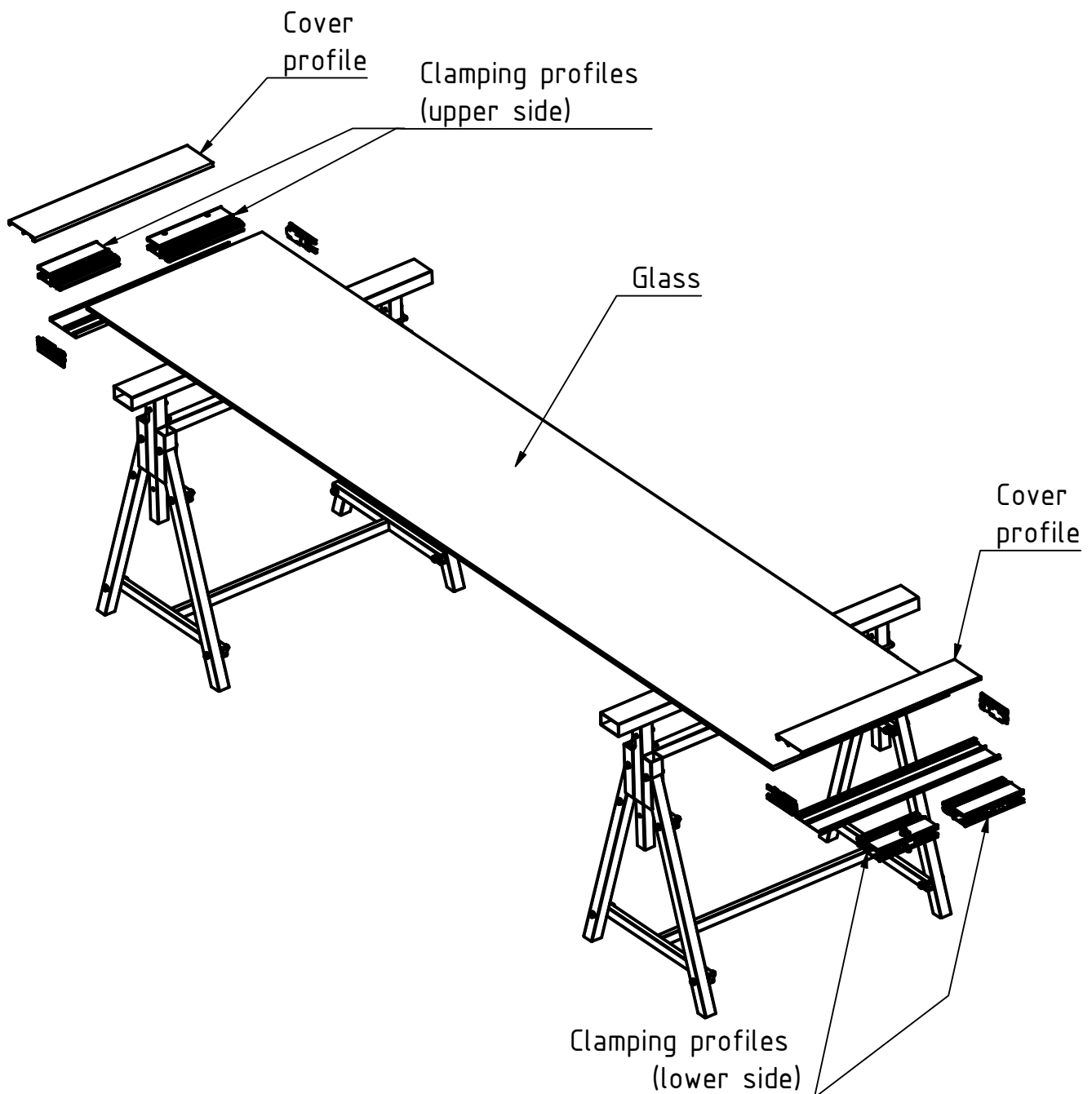

STEP-2:

The job that has to be done is the assembly of the clamping profiles and their covers on the glass. Two (2) pieces of alum. clamping profile have to be assembled at each side of the glass panel (upper and lower side). Above of them their covers must be assembled also.

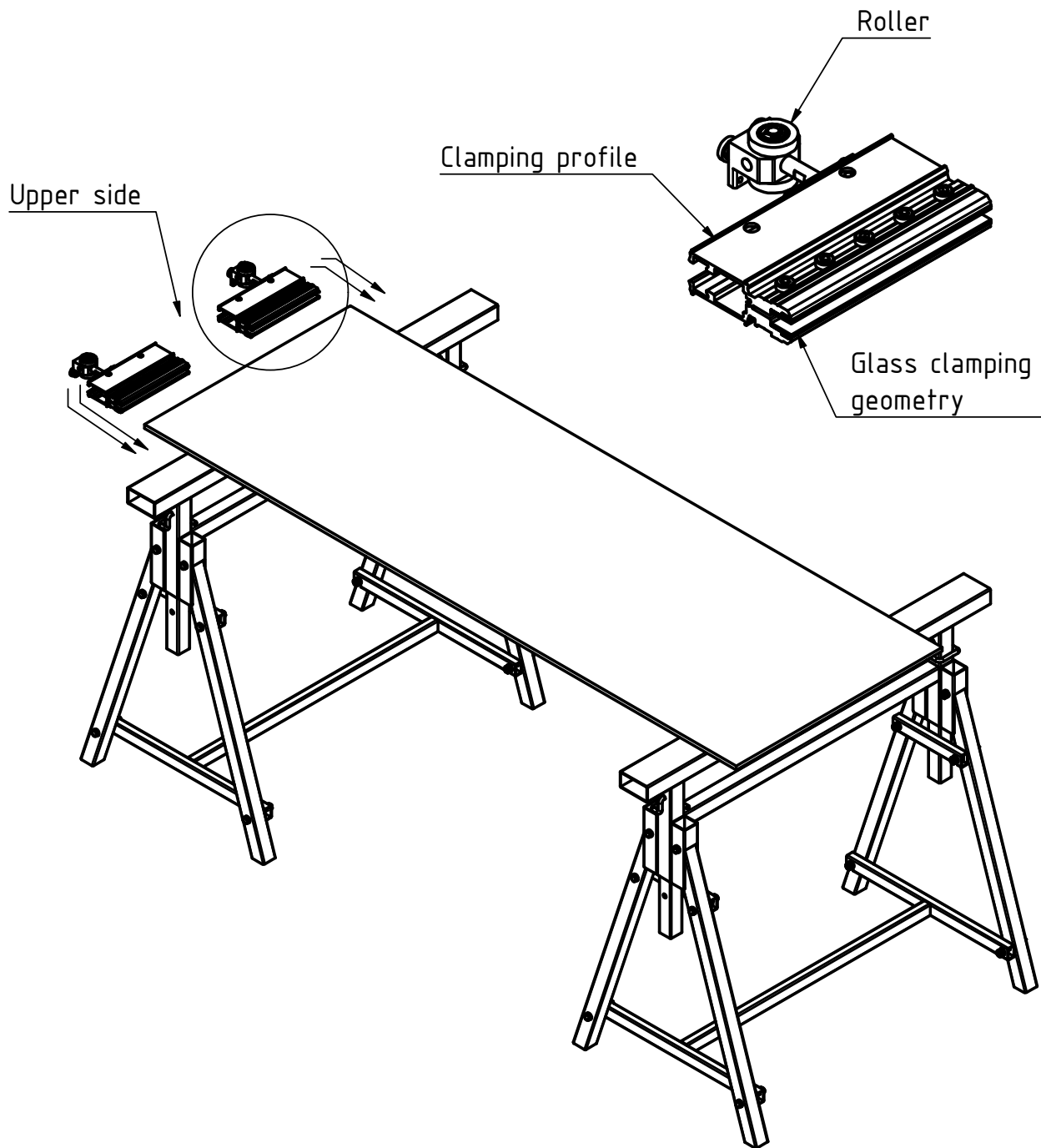

PANELS B, C & E (Kit):

STEP-1A:

At the glass assembly the upper clamping profiles.
These profiles include the rollers.

The assembly of the clamping profile to the glass must be done at 13mm from the glass edge.

Also check that the roller is placed at 70mm distance from the glass edge.

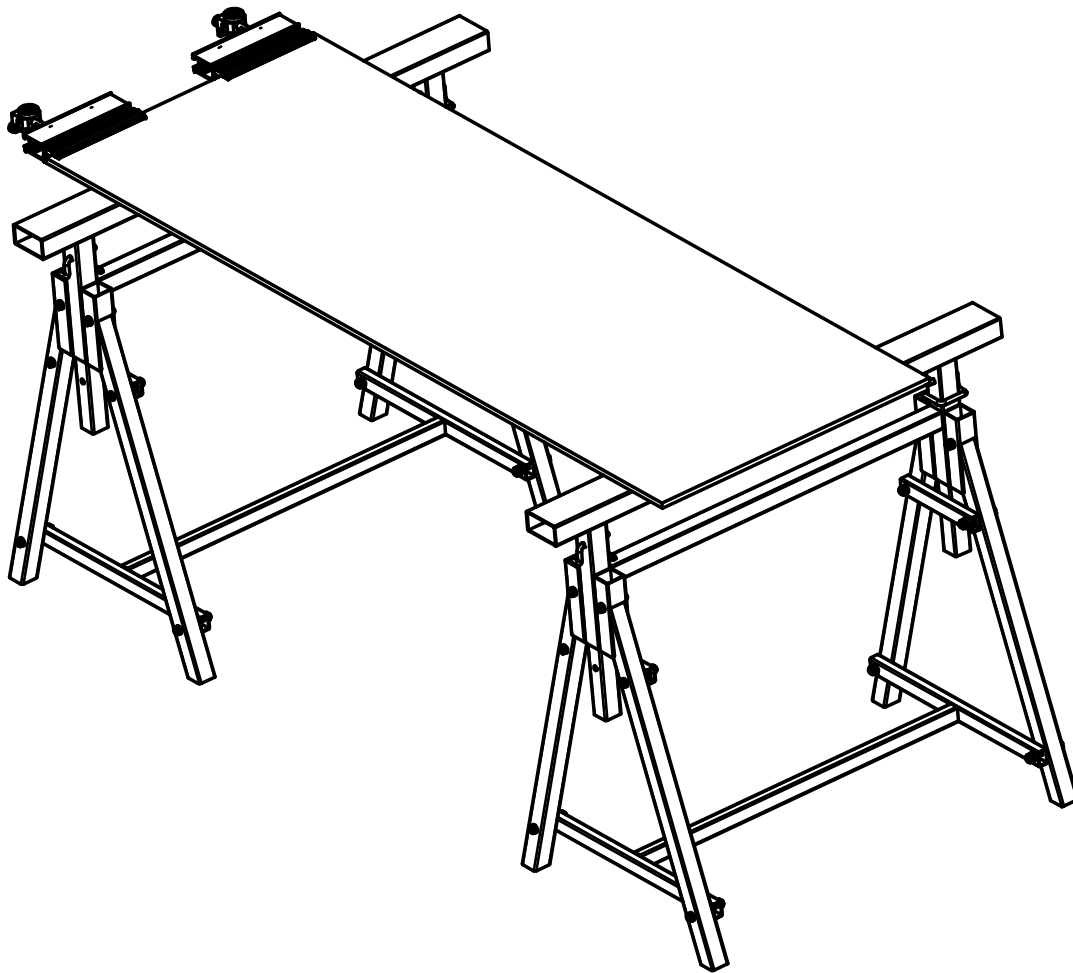
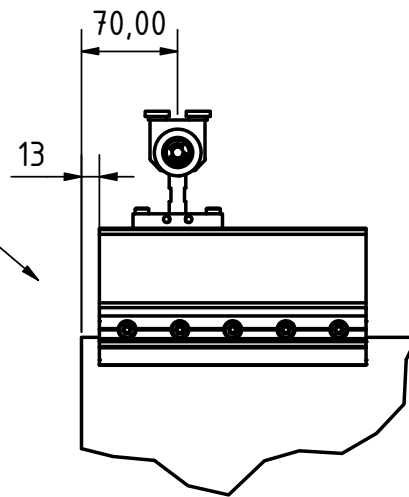

STEP-1B:

Place the upper clamping profiles at a certain position.

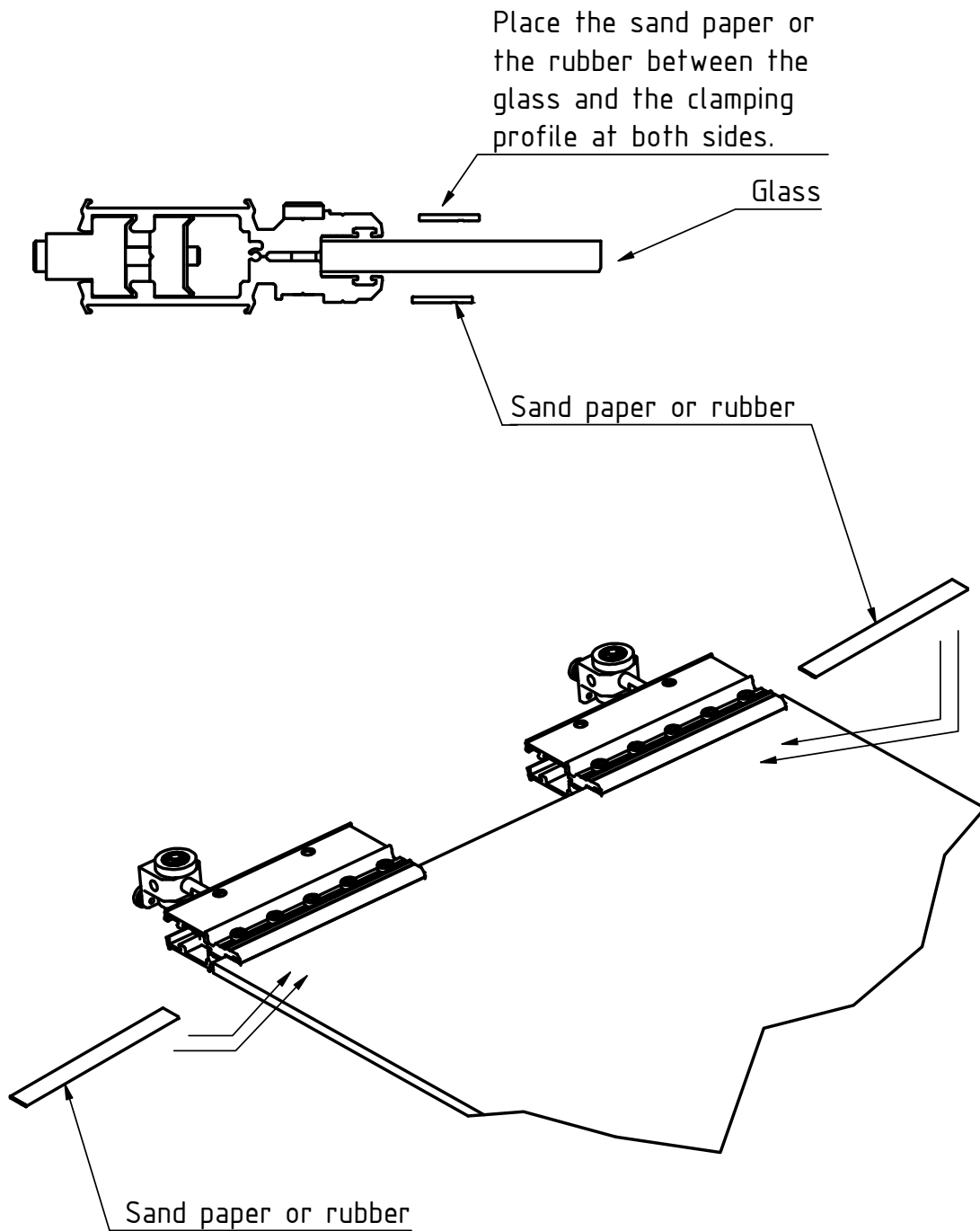

STEP-2:

Install the sand paper or rubber between the glass surface and the clamping profile.

Use a 6.0mm allen key in order to tight
ONLY the edge screws of the clamping profile.
Apply 20Nm torque.

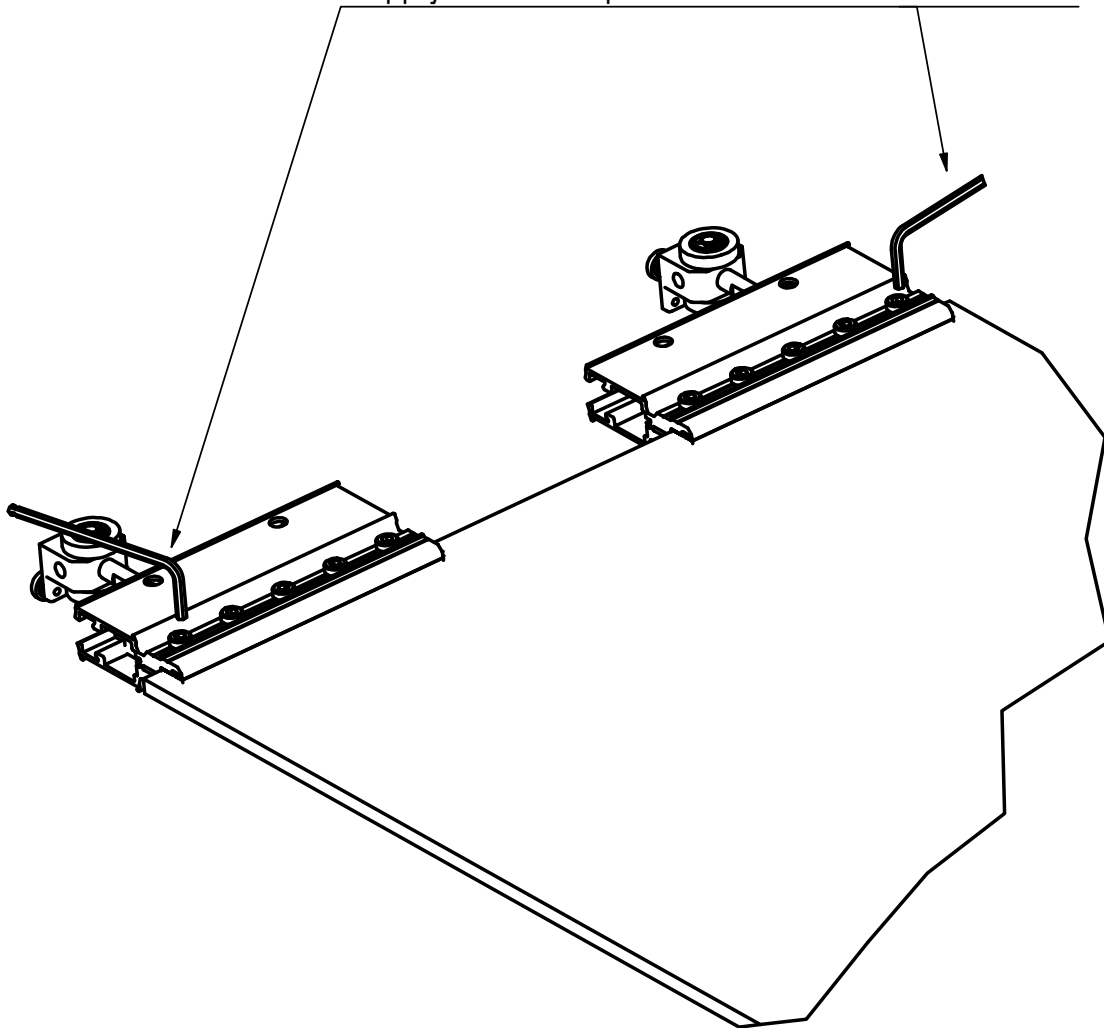

STEP-3:

Tighten each one of the screws located at the edge of the clamping profile.

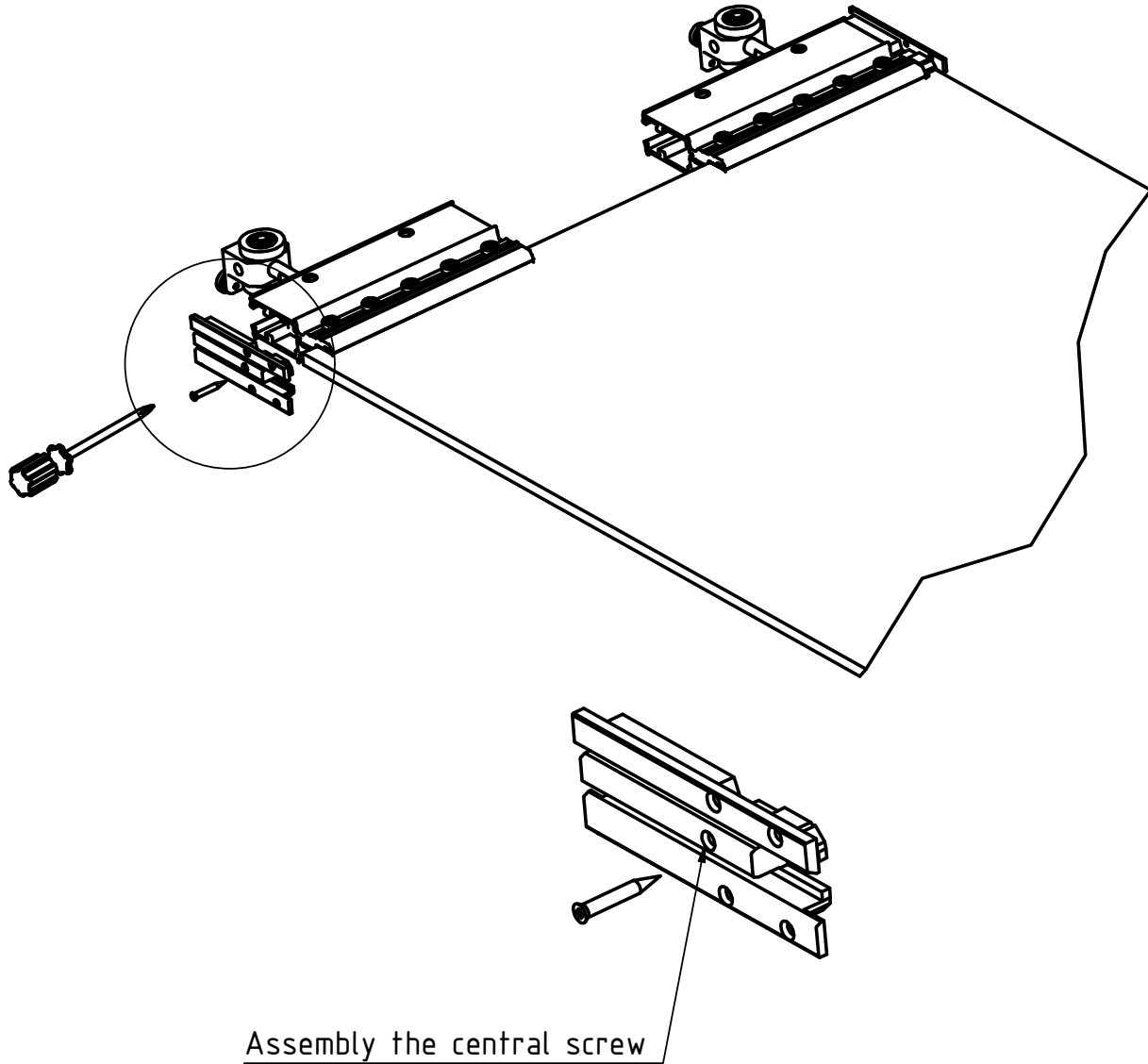

STEP-4A:

Assembly the plastic cover at both sides.

Assembly only one screw - the central with the clamping profile.

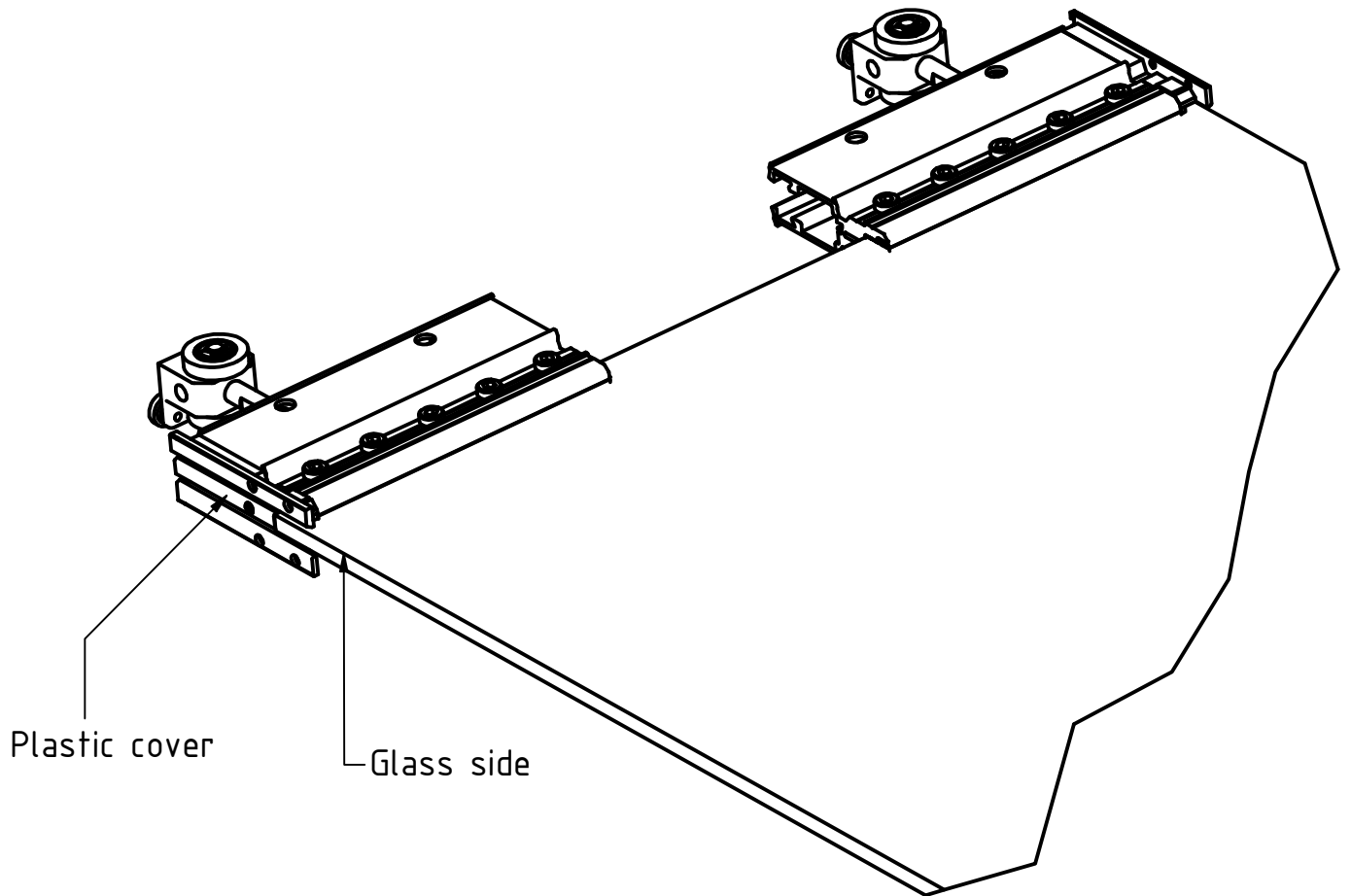

STEP-4B:

Assembly the plastic cover at both sides.

Check the alignment between the plastic cover and the glass side.

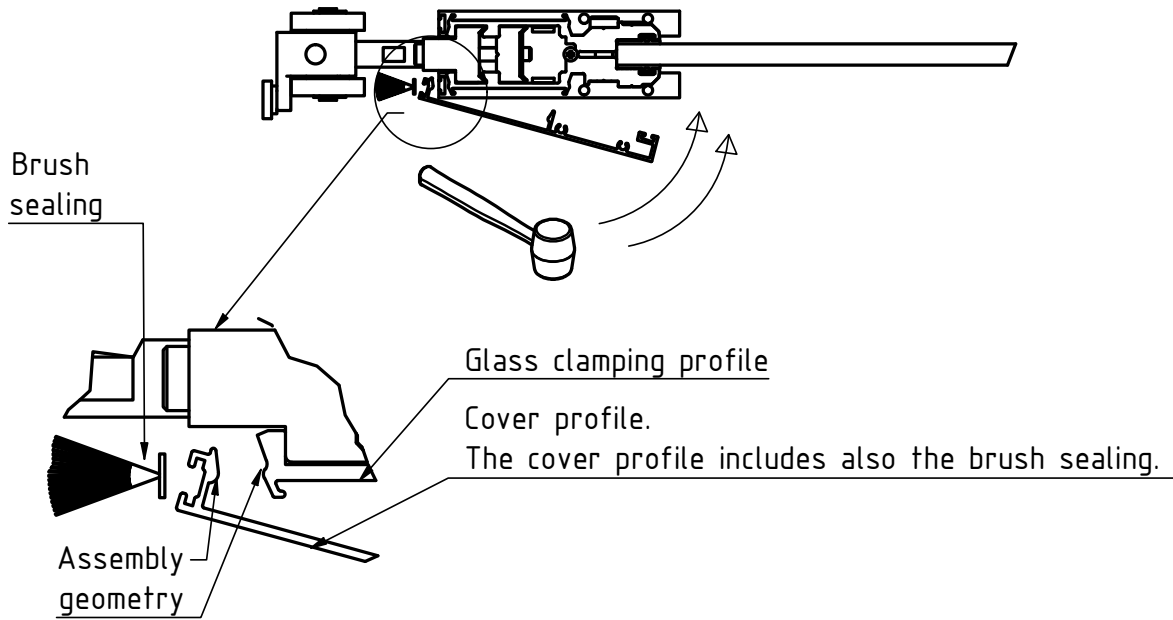
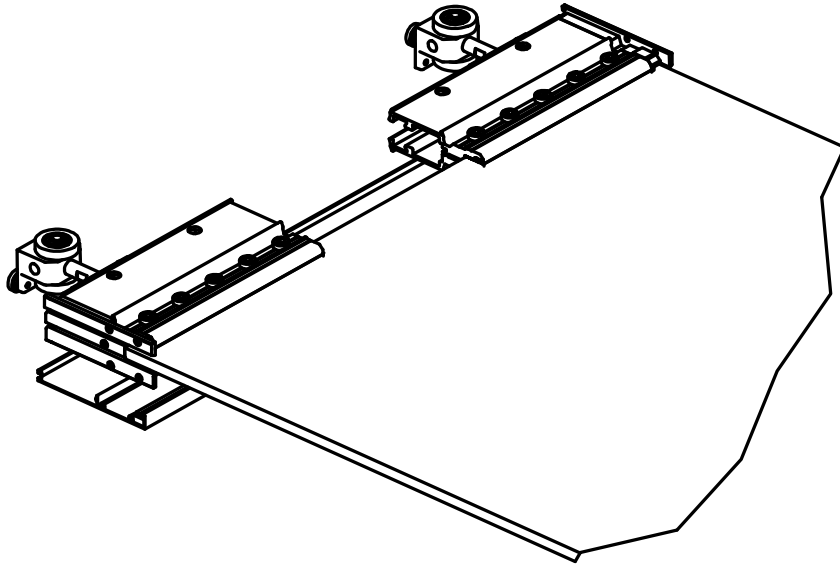

STEP-5:

Assembly lower cover profile.

Place it first at the assembly geometry of the clamping profile and then close it towards the glass. Apply small force at the final stage in order to secure assembly.



Use a 6.0mm allen key in order to tight
ALL the screws of the clamping profile.
Apply 25Nm torque.

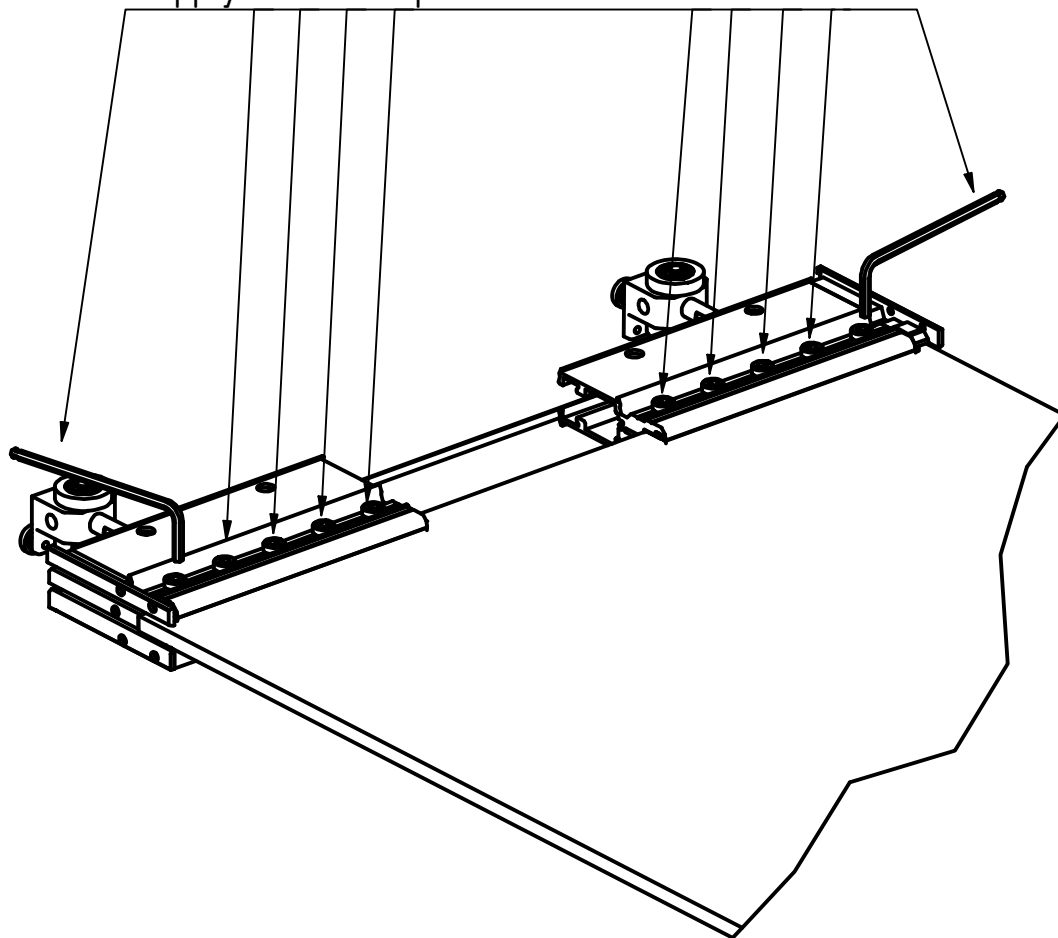

STEP-6:

Finalize the assembly of the glass with the upper clamping profiles.
Tight all the screws.

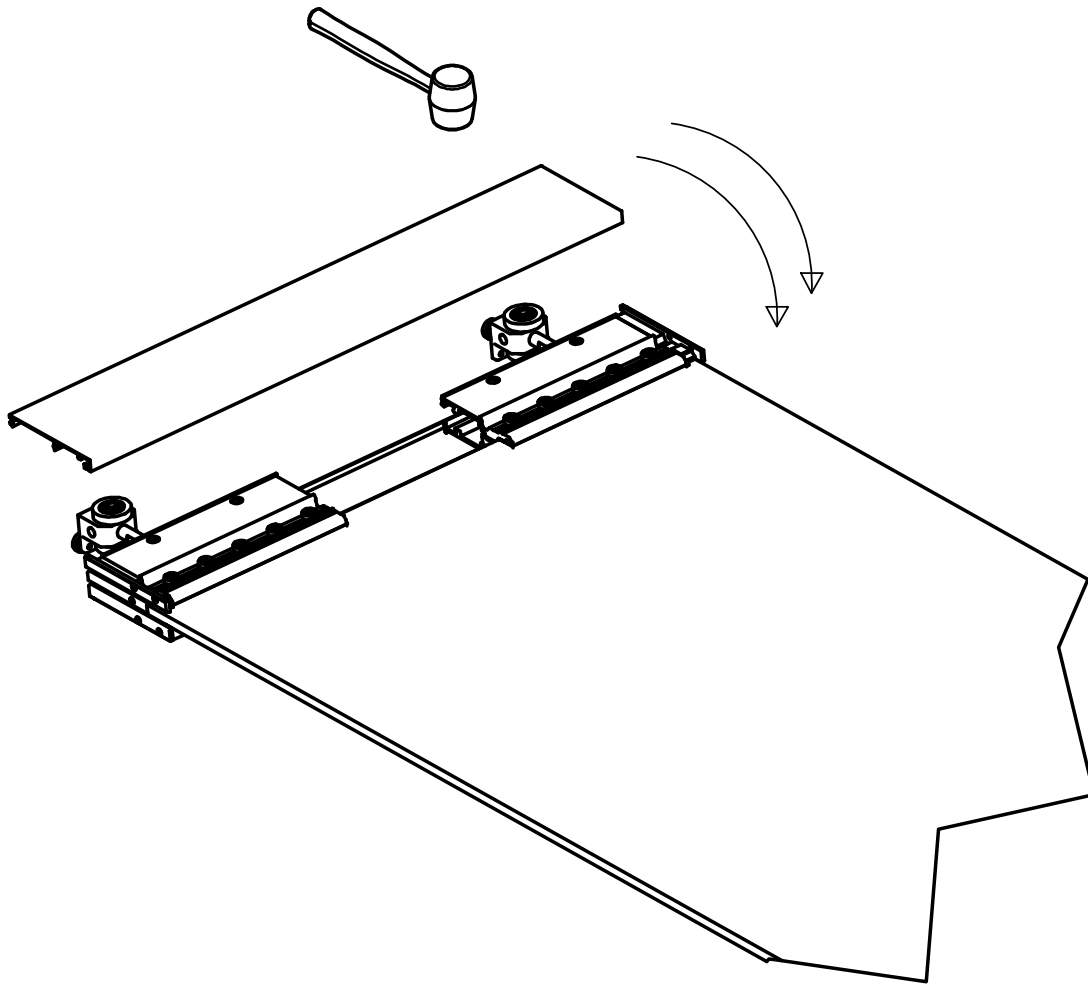

STEP-7:

Assembly upper cover profile.

Place it first at the assembly geometry of the clamping profile and then close it towards the glass. Apply small force at the final stage in order to secure assembly. Same like STEP-5.



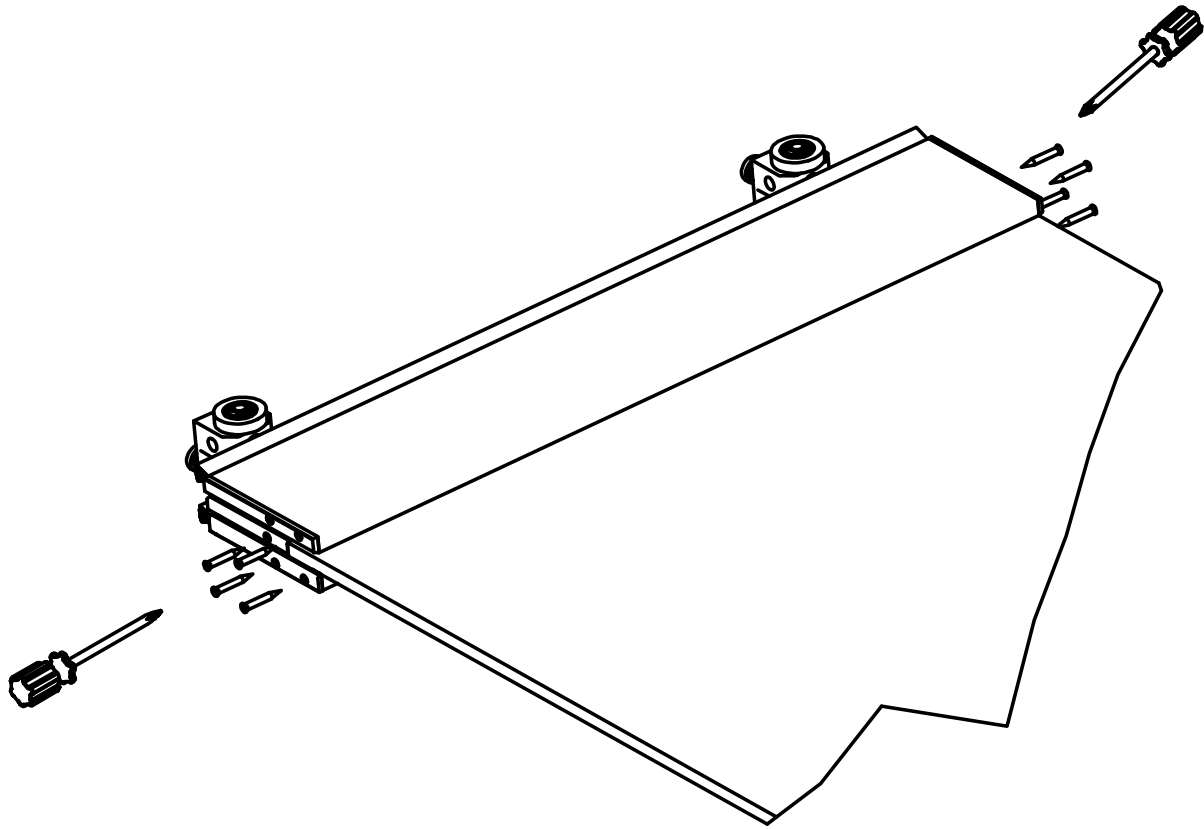

STEP-8:

Assembly the remaining 4 screws of the two (2) plastic covers with the two cover profiles at both sides.

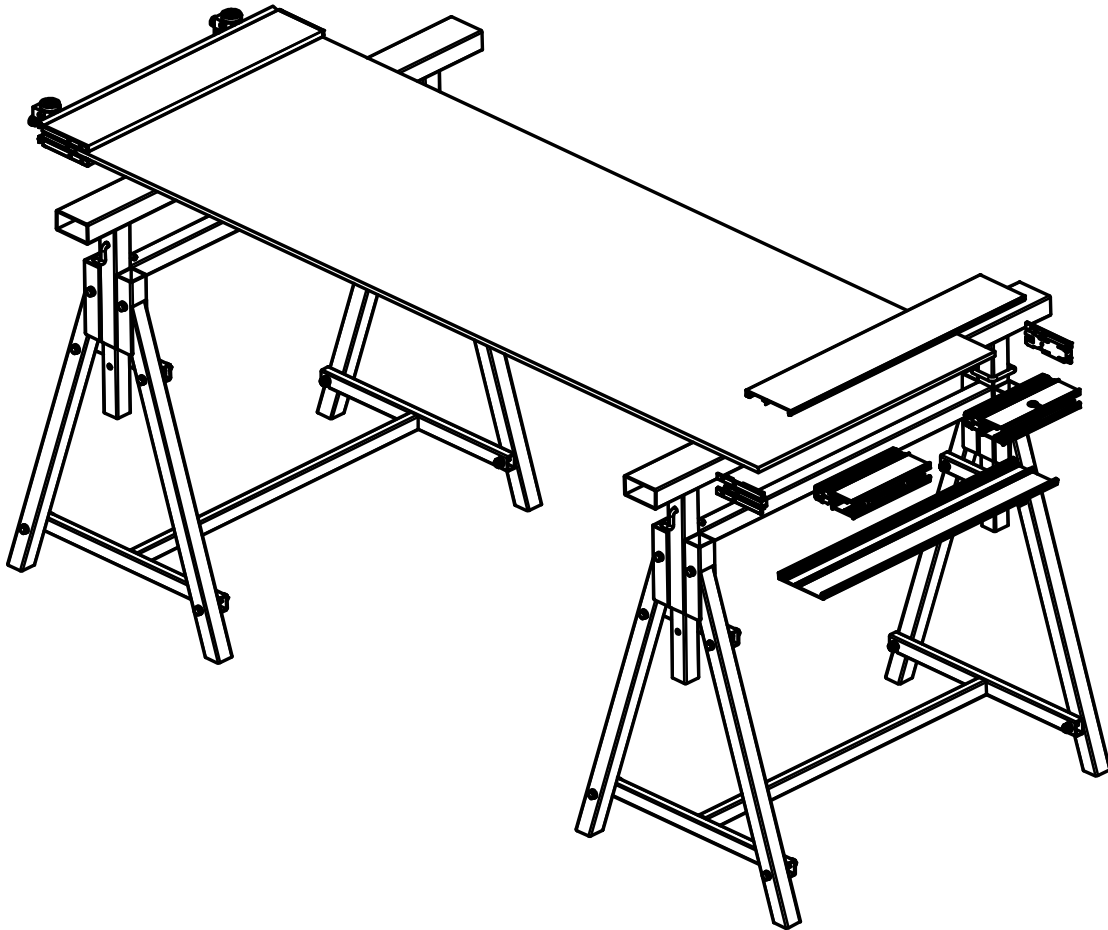

STEP-9:

Assembly the parts for the lower side of the glass panel.
Follow the steps from 1 to 8 mentioned before for the similar parts.



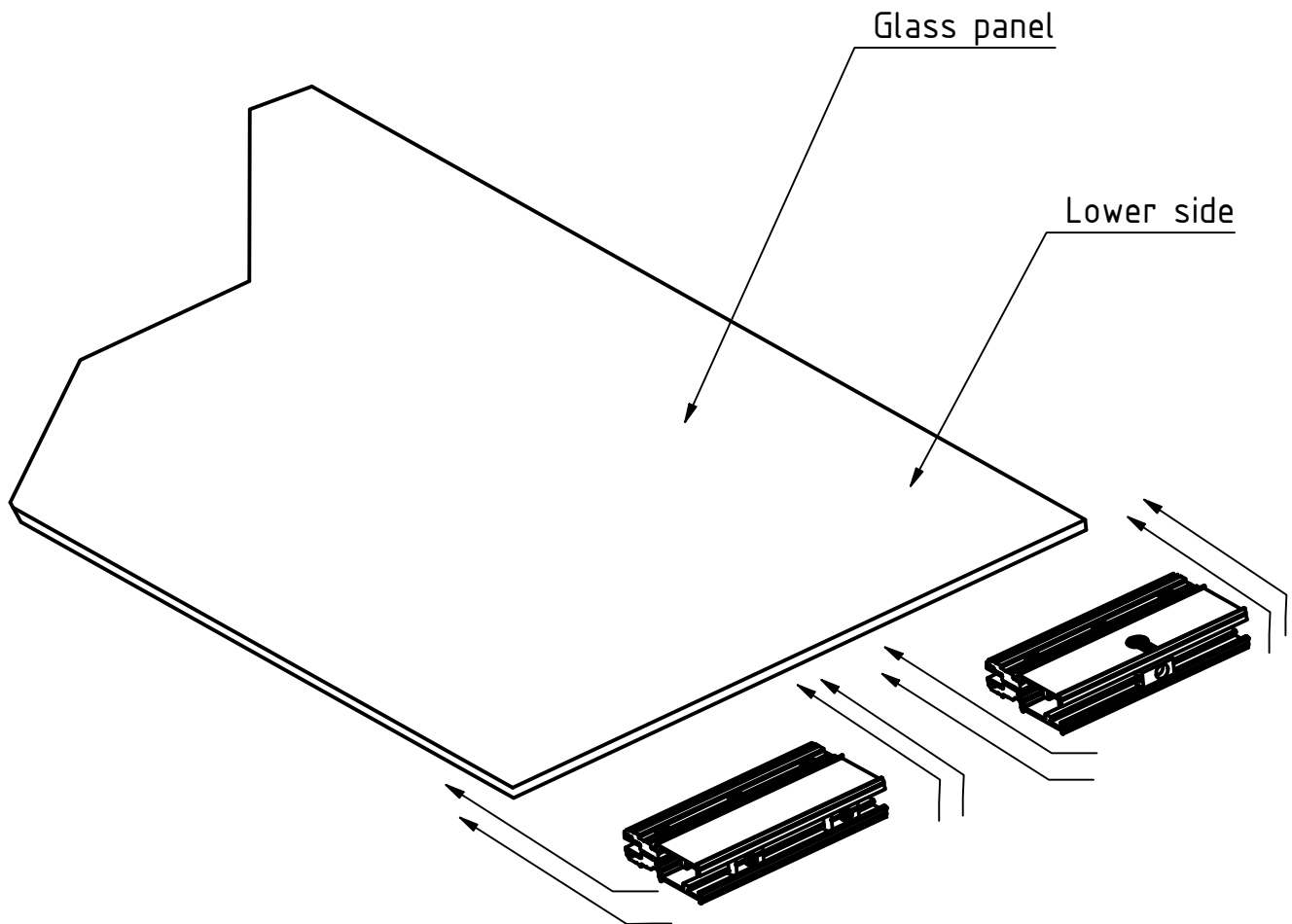

STEP-10:

Assembly the glass the lower clamping profiles.

These profiles include bolts or locks. Same like steps 1A & 1B.

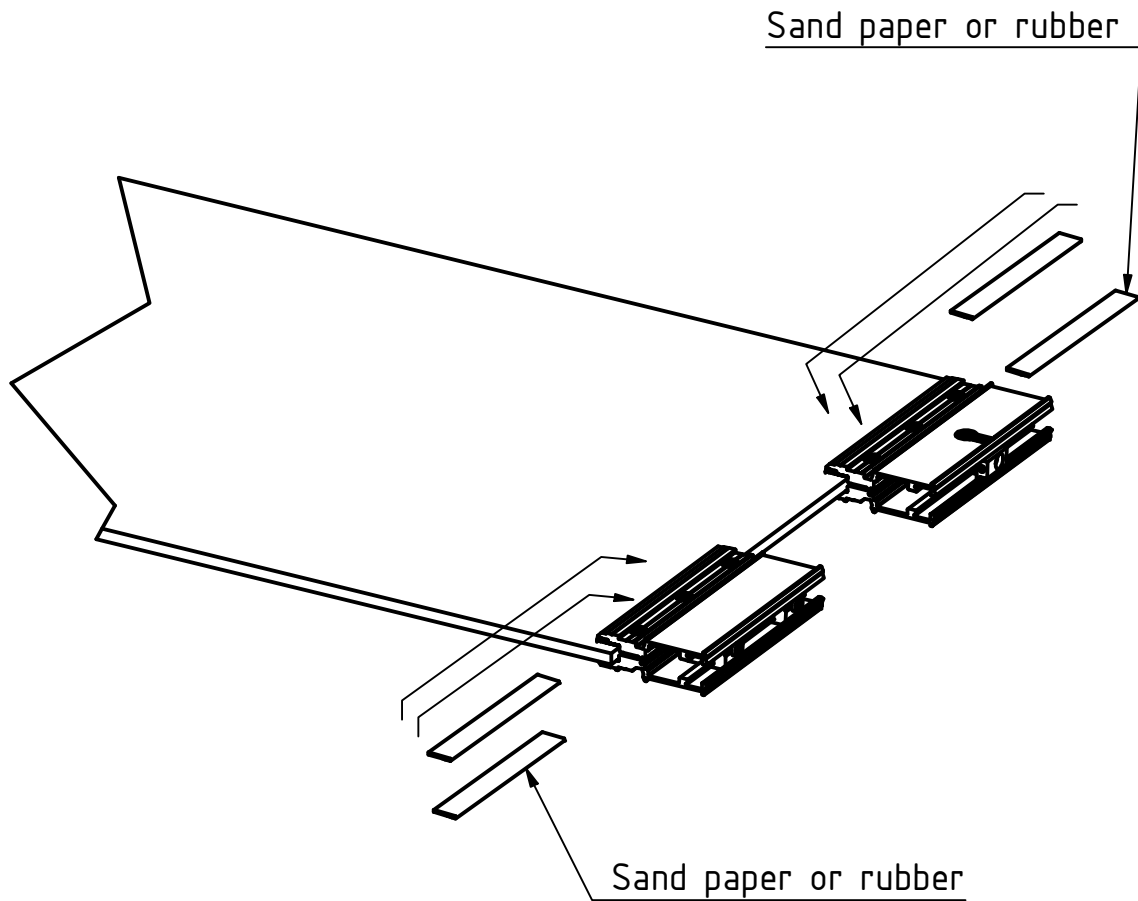

STEP-11:

Install the sand paper or rubber between the glass surface and the clamping profile. Same like STEP-2.

Use a 6.0mm allen key in order to tight
ONLY the edge screws of the clamping profile.
Apply 20Nm torque.

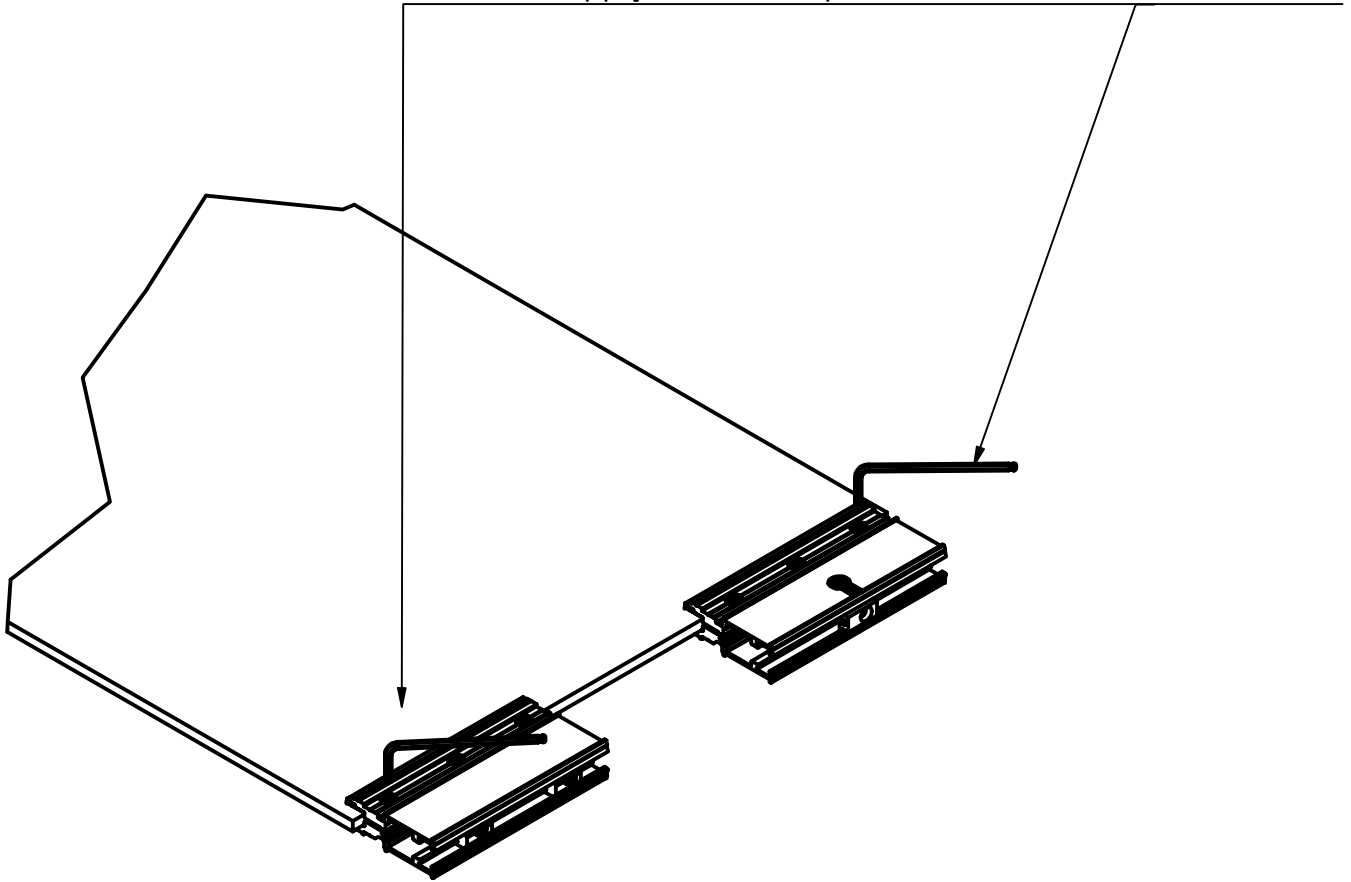

STEP-12:

Tighten each one of the screws located at the edge of the clamping profile. Same like STEP-3.



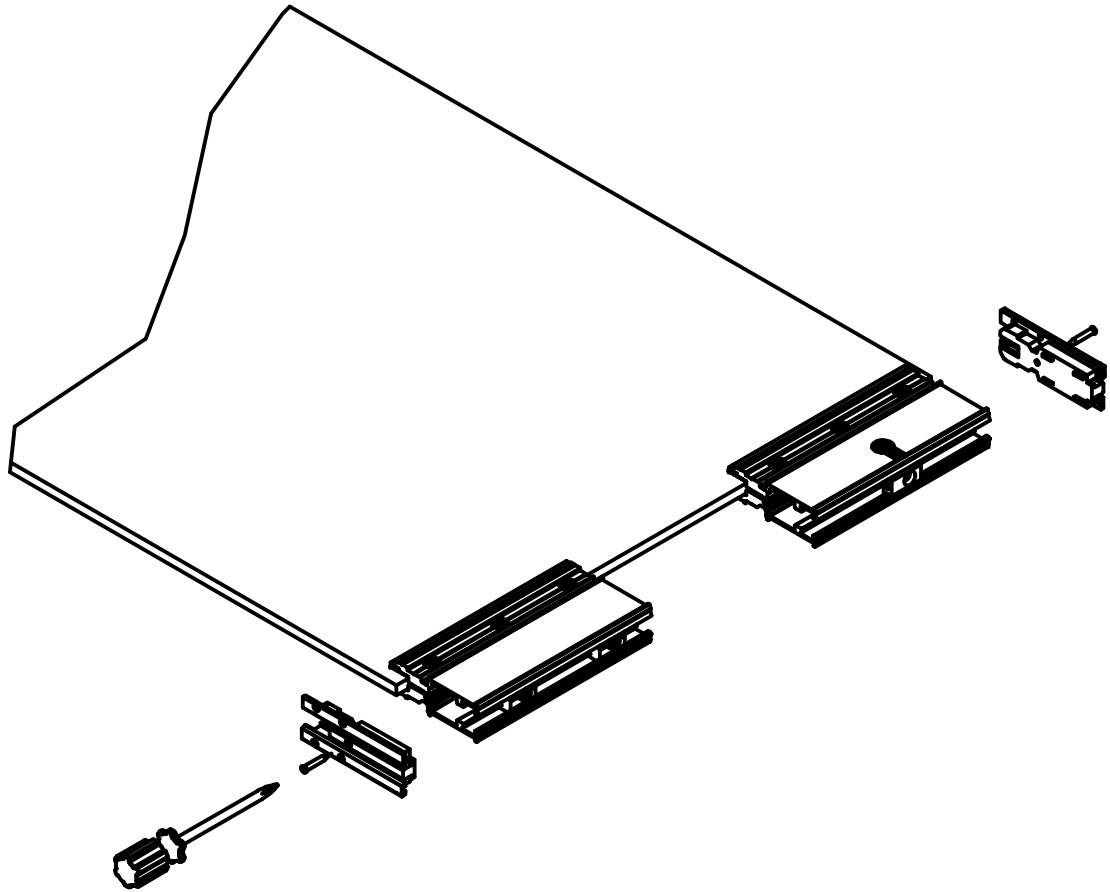

STEP-13:

Assembly the plastic cover at both sides.

Assembly only one screw - the central with the clamping profile.

Same process like STEP-4A. Also check the alignment with the glass panel like STEP-4B.

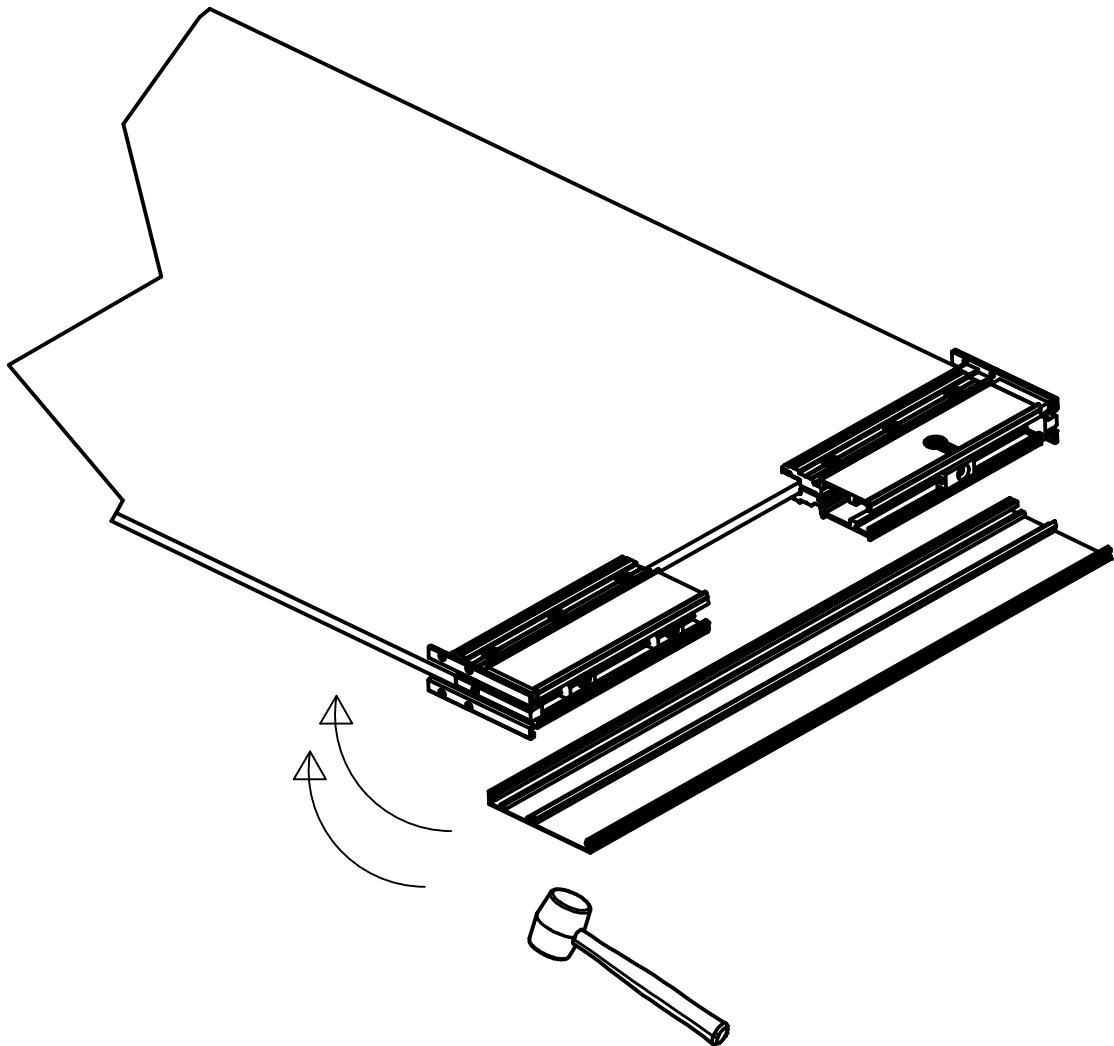

STEP-14:

Assembly lower cover profile.

Place it first at the assembly geometry of the clamping profile and then close it towards the glass. Apply small force at the final stage in order to secure assembly. Same procedure like STEP-5.

Use a 6.0mm allen key in order to tight
ALL the screws of the clamping profile.
Apply 25Nm torque.

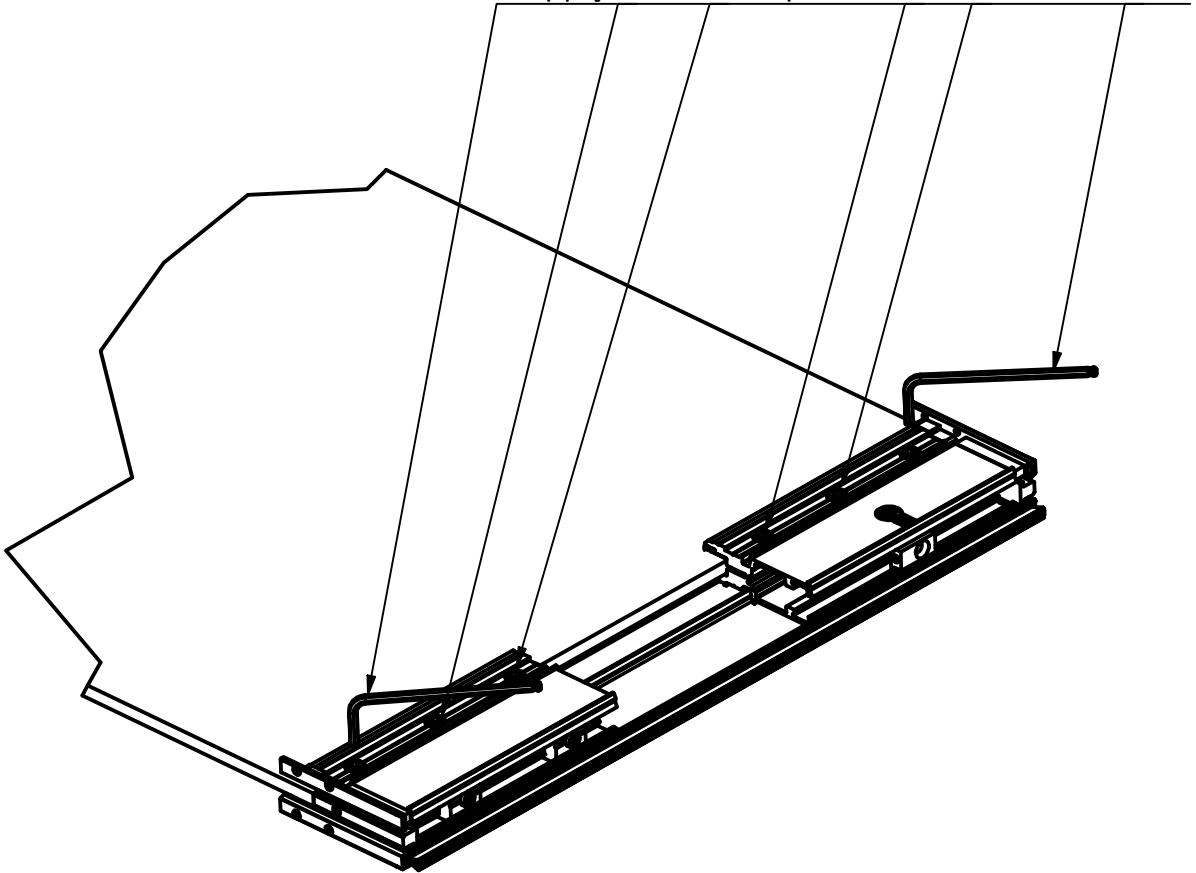

STEP-14:

Finalize the assembly of the glass with the lower clamping profiles.
Tight all the screws. Same like STEP-6.

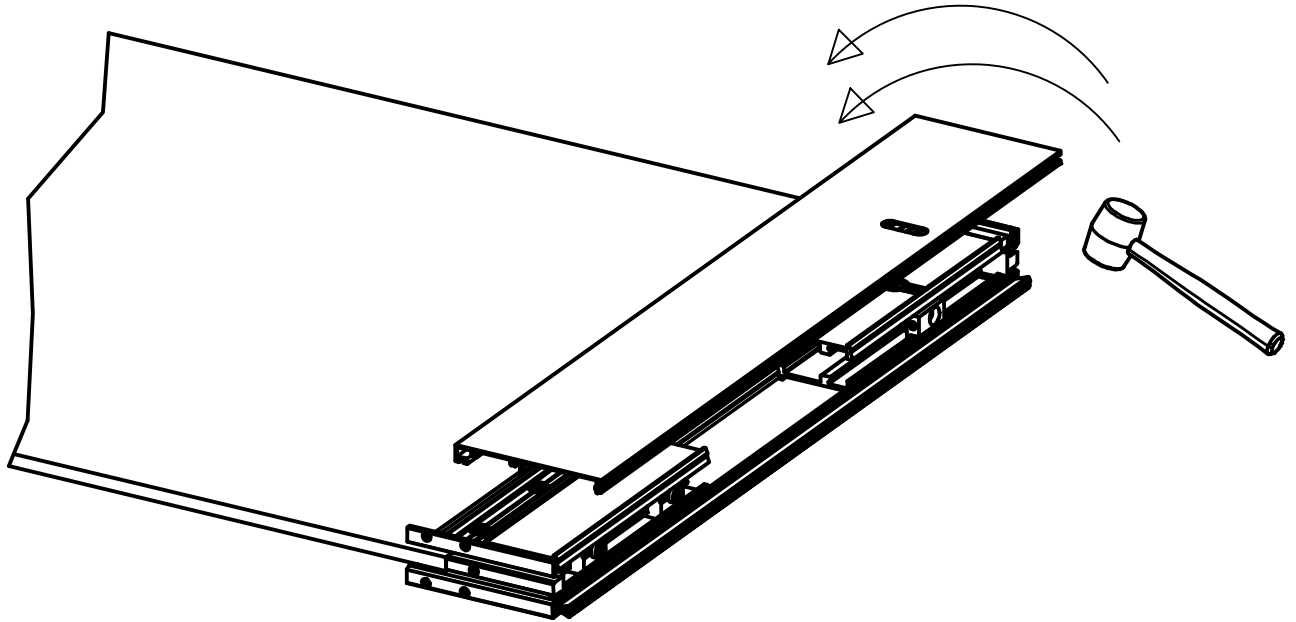

STEP-15:

Assembly upper cover profile.

Place it first at the assembly geometry of the clamping profile and then close it towards the glass. Apply small force at the final stage in order to secure assembly. Same like STEP-7.

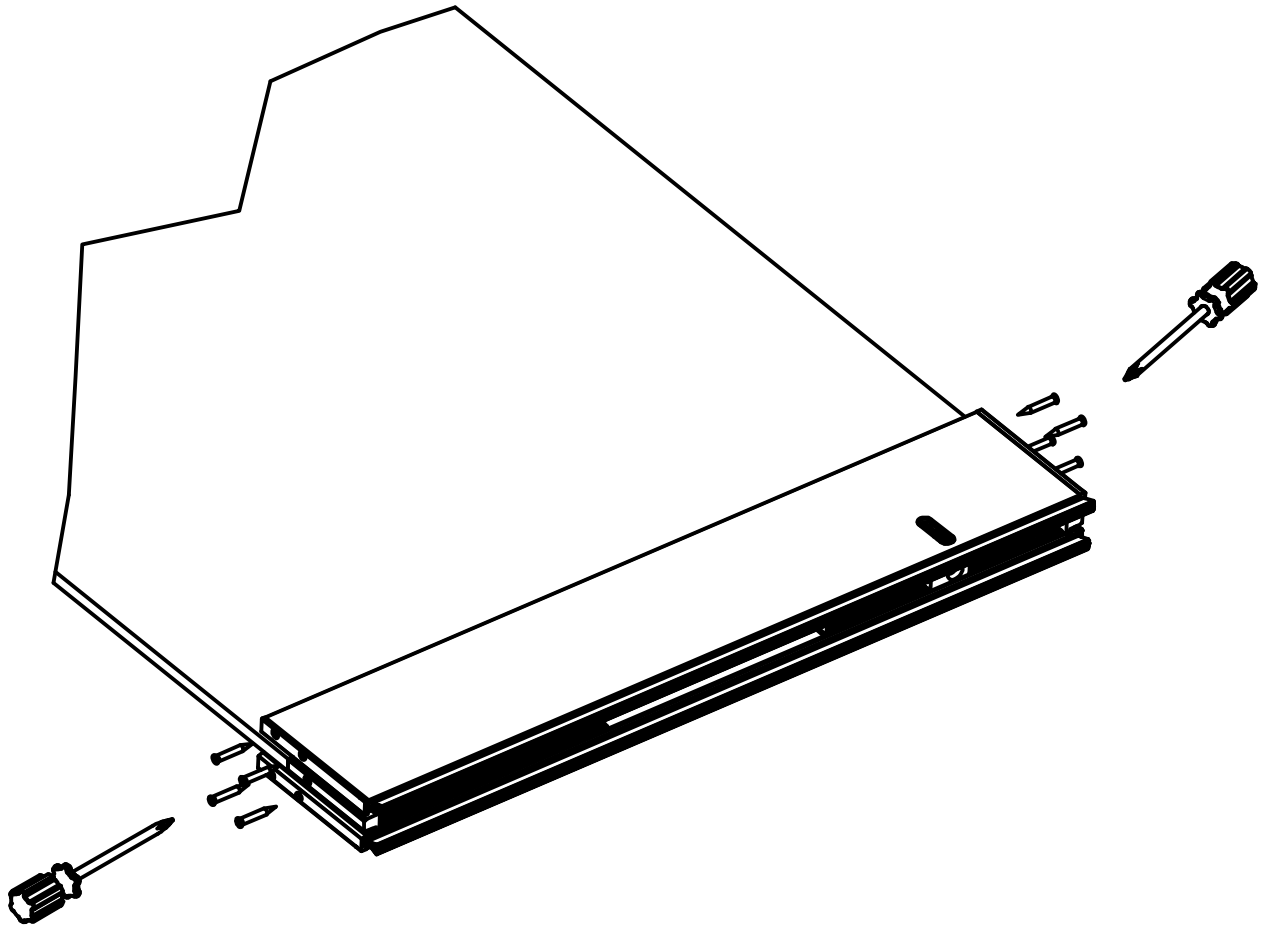

STEP-16:

Assembly the remaining 4 screws of the two (2) plastic covers with the two (2) cover profiles at both sides. Same like STEP-8.

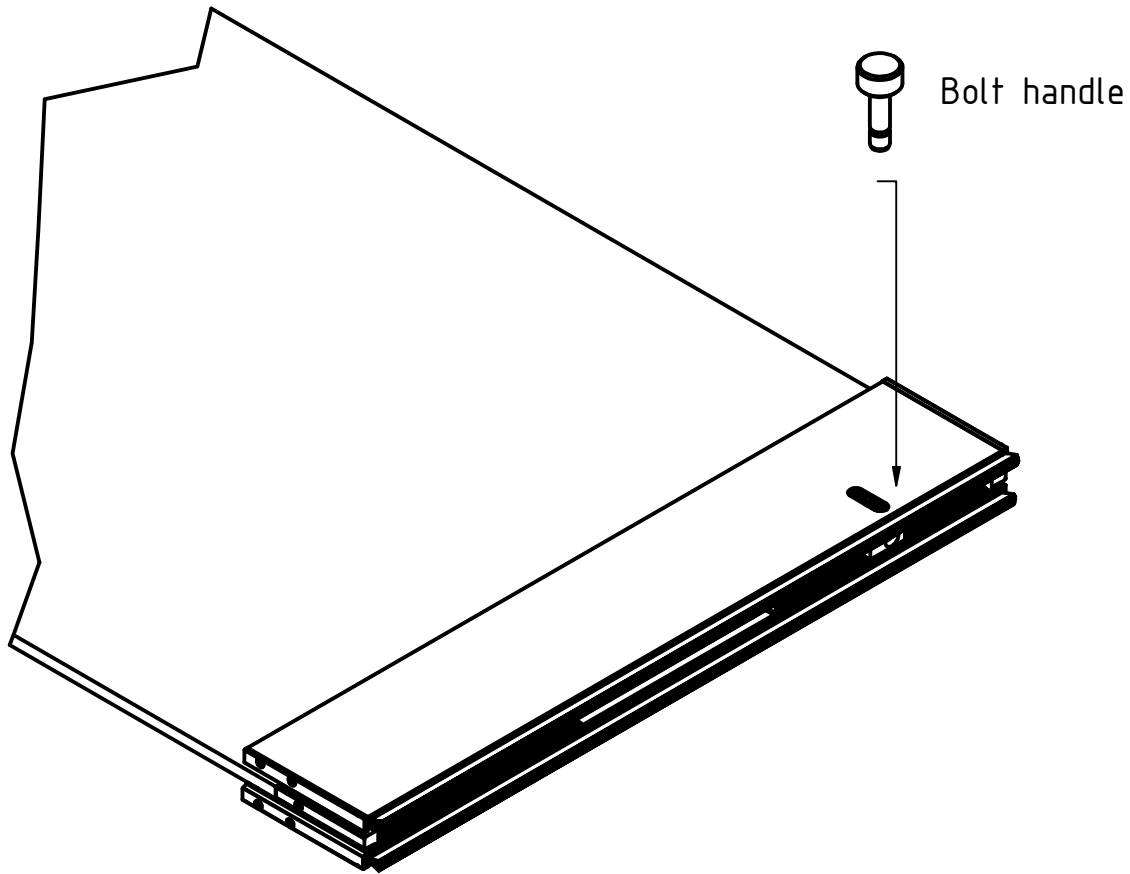

STEP-17:

Assembly the parts for the locks and bolts.

